

Proposed Ground Floor Plan 1:100

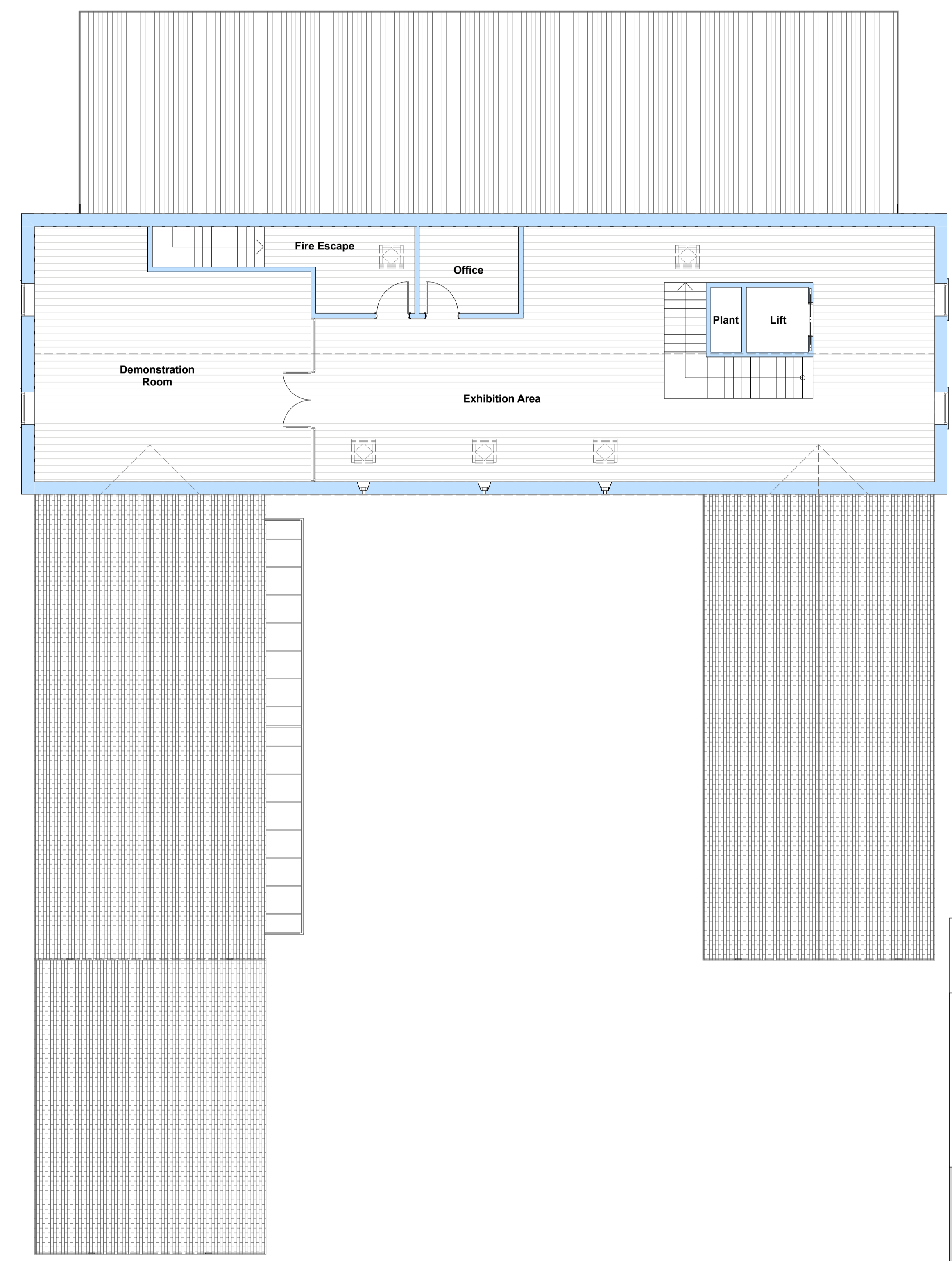

Proposed First Floor Plan 1:100

**TOTAL GIFA -
882m² (9,493ft²)**

PRELIMINARY

© This drawing and the works depicted are the copyright of Lime Architecture Ltd and may only be reproduced with written permission. No alteration to the design or specification in part or whole to be made without the written approval of the Lime Architecture Ltd. All dimensions and levels depicted are subject to checking on site. Any discrepancies to be immediately notified to office of origin. Figure dimensions only to be used. Scale at your own risk. The information contained in this drawing must only be used at the named location. The location of any services indicated on this drawing are approximate only and must be checked on site by the main contractor before commencing works. It is considered that a competent contractor will be able to identify hazards associated with the project from the information above, and take the necessary precautions to deal with any risks to health and safety.

Rev	HC	Date	Description
	HC	20.02.23	Amended to client comments.

lime
Lime Architecture Ltd
Unit 8 Parichfields Enterprise Park
Cotton Road
Rugeley
Staffordshire
WS15 3HB
Tel: 01889 579777
www.lime-architecture.co.uk
email: info@lime-architecture.co.uk

Client **Hartington Creamery Ltd**

Project **Land Adj. to Peakland Grange, Stonewell Lane, Hartington - Proposed Visitor Centre**

Layout Title **Proposed Plans**

Layout Status **PRELIMINARY**

Drawing No. **2021-14-101** Revision: **D**

Drawn: HC Checked: AE
Date: 20/02/2023 Scale: 1:100 @ A1